

OFV 5

ISOLATION VALVE

- Compact isolation valve.
- For use with the KBB Fire Valve range.
- Prevent back-flow spillage.
- Easy to install and compliments existing system.

Application

For use on bottom take-off connections on steel or plastic domestic liquid heating fuel (LHF) tanks.

The isolating valve is positioned in the LHF feed pipe, usually near the tank, running to the boiler. This insures that the LHF supply can be quickly turned off, for example, during boiler servicing.

Fitted after the LHF filter valve, the isolation valve is used to prevent back-flow spillage from the boiler side of the system.

Outline Details

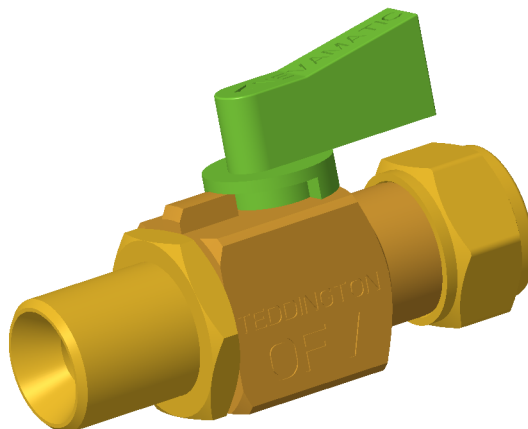
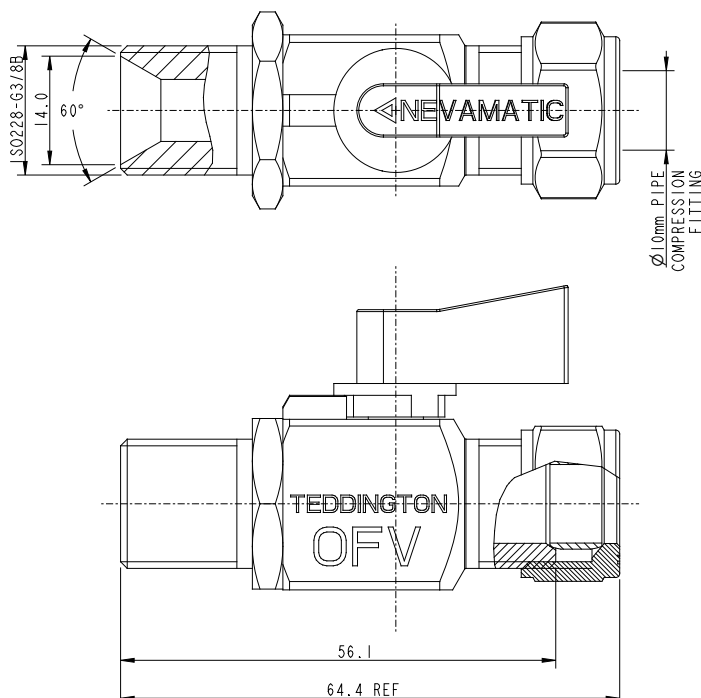

Technical Specification

Material:

Valve Body: Brass
Valve adaptor: Brass

Connection sizes:

In: 3/8" BSPP
Out: 10mm compression with copper olive

Valve size: DN8

Weight: 105g

Media:

- Kerosene
- Biofuels
- Hydrotreated Vegetable Oil (HVO)

Operation: 90 degree lever rotation to 'off' condition (drawn in 'open' condition).



Smart Control Systems
for a Sustainable Future
part of the Teddington Group

Manufactured by

Teddington Appliance Controls Ltd

Part of the Teddington Group

Holmbush · St. Austell · Cornwall · United Kingdom · PL25 3HG

Tel: +44 (0) 1726 222505 · Fax: +44 (0) 1726 222502

www.tedcon.com · info@tedcon.com



Iss C - 04/23