

## OFV 9

### FILTER & ISOLATION VALVES

- Liquid heating fuel filter and isolation valve in one tidy, robust and compact unit.
- For use with the KBB Fire Valve range.
- Avoid expensive engineer call outs.

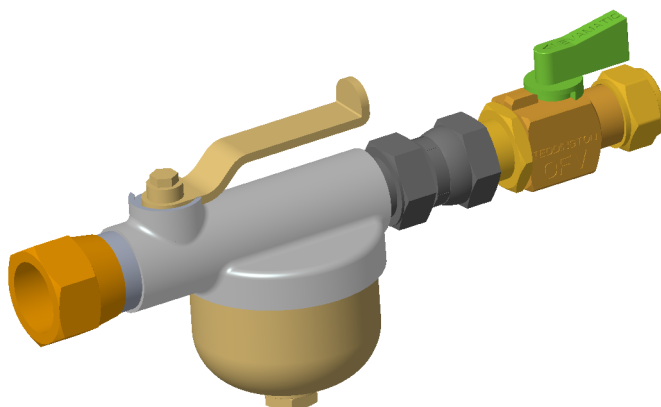

#### Application

For use on bottom take-off connections on steel or plastic domestic liquid heating fuel (LHF) tanks.

The filter and isolating valve is positioned in the LHF feed pipe, usually near the tank, running to the boiler. This insures that the LHF supply can be quickly turned off, for example, during boiler servicing.

The OFV is fitted with nylon filters to trap coarse particles; this is important because the smallest particle of dirt or rust can permanently damage a boilers LHF pump and/or block the very fine LHF atomising jet.

#### Technical Specification

##### Material:

Isolation Valve Body (outlet): Brass  
Filter Valve Body: Aluminium  
Filter bowl: Steel  
Filter: Nylon

##### Connection sizes:

In: 1/2" BSP (female)  
Out: 10mm compression with copper olive

**Flow rate:** 150 l/hr at 1m head

**Weight:** 480g

##### Media:

- Kerosene
- Biofuels
- Hydrotreated Vegetable Oil (HVO)

#### Outline Details

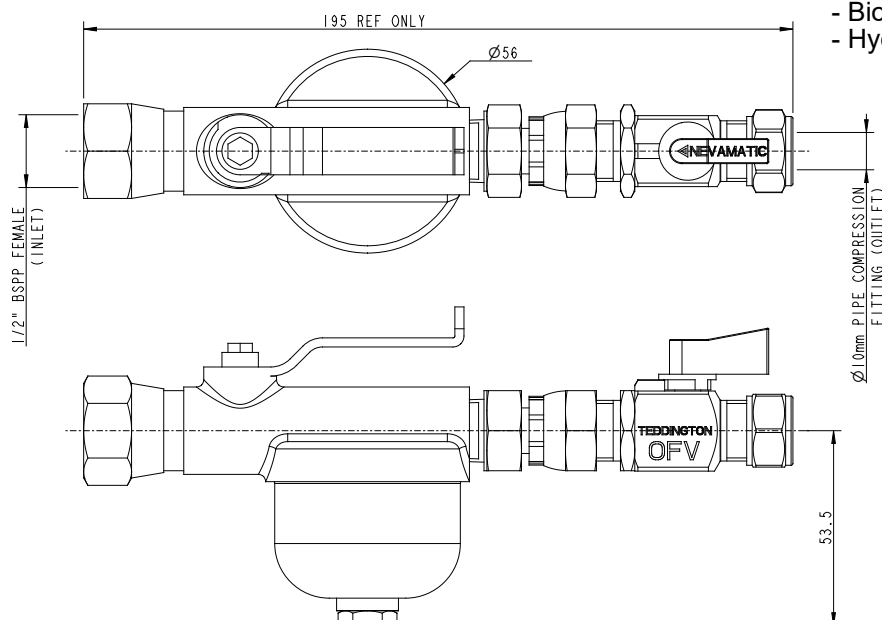

Smart Control Systems  
for a Sustainable Future  
part of the Teddington Group

Manufactured by

**Teddington Appliance Controls Ltd**

Part of the Teddington Group

Holmbush · St. Austell · Cornwall · United Kingdom · PL25 3HG

Tel: +44 (0) 1726 222505 · Fax: +44 (0) 1726 222502

www.tedcon.com · info@tedcon.com



Iss C - 04/23